

4 x  $\varnothing$  0.1654  $\nabla$  0.669  
M5x0.8 - 6H  $\nabla$  0.472

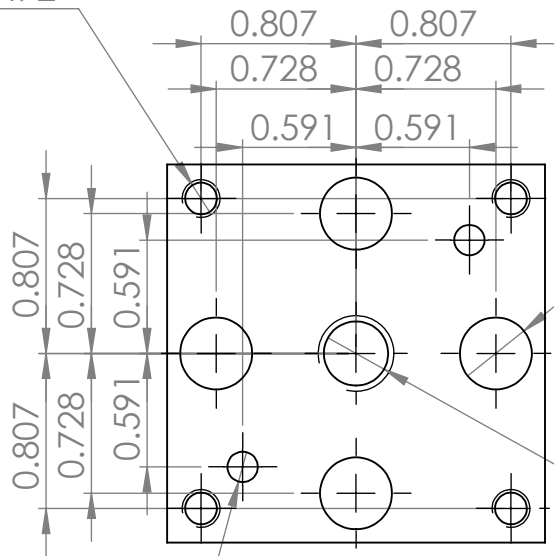

$\varnothing$  0.375 CLEARANCE  $\nabla$  0.157

$\varnothing$  0.3346  $\nabla$  0.906  
M10x1.5 - 6H  $\nabla$  0.669

2 x  $\varnothing$  Drill  $\varnothing$ .1540  $\nabla$  0.276  
Ream 4.02mm  $\nabla$  0.276

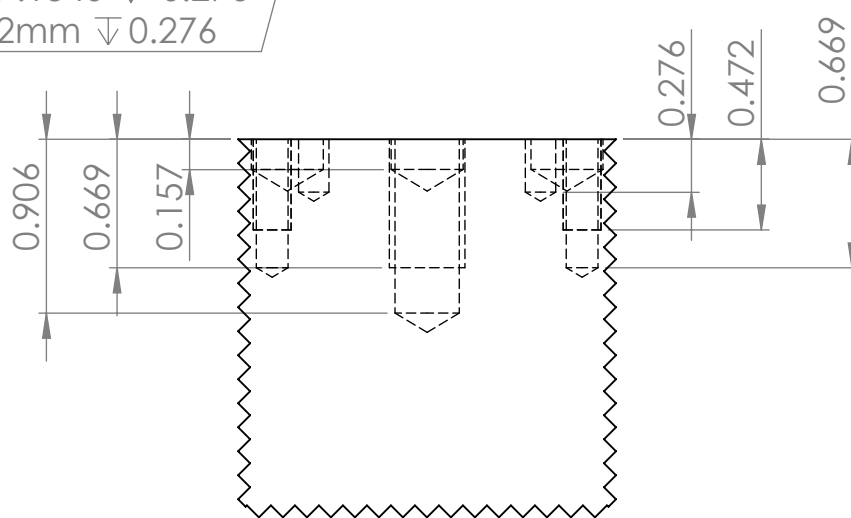

EROWA 50mm